



Installation Manual

Alarm

Connection Box



Table of Contents

GETTING STARTED	3
UNPACKING.....	3
CONNECTION TO THE ALARM SYSTEM.....	3
CONNECTION TO SENSORS AND EXTERNAL UNITS	4
12V CONNECTION	4
OUTBOARD ENGINE ALARM.....	5
MAINTENANCE.....	6
TECHNICAL SPECIFICATIONS	6
SAFE DISPOSAL	6

Getting started

Congratulation with your new SuperSail product. We hope that you will be satisfied with the product and we are always available to give support in case you need it.

You can contact us at: support@super-sail.dk

Regards,

SuperSail Support Team

Please read the whole installation manual before starting the installation.

Unpacking

Before you start using the unit you must ensure that the packaging has not been broken or have been injured during transport and that the product is complete and without any visible sign of damage or strained. If this is not the case please contact SuperSail before using the product.

The Alarm Connection Box consist of:

- Connection Box
- Base plate with terminal blocks
- Bag with 4 screws for mounting the base plat to the Connection Box
- 1 pcs. 1KOhm resistor for Outboard Engine alarm

Connection to the Alarm system

Before connecting Alarm sensors and other units to the Connection Box, it must be connected to the SuperSail Marine Alarm Wireless.

The SuperSail Marine Alarm Wireless must not be connected to external power supply while connecting the wires. The cable from SuperSail Marine Alarm Wireless are stripped so the bare wires have a length of approx. 10 cm. The cable is lead into to the Connection Box via the gland, which is tightened slightly without using tools.

The following wires can be cut off – they are not to be used:

- Pink
- Brown

The remaining wires must be connected to the terminal block in the right terminal number. The wires must be connected to the terminal numbers as shown in the below picture.

Each wire is stripped and connected to the terminal number as follows:

1. Grey
2. Orange
3. Yellow
4. Blue
5. Light Blue
6. Purple
7. Green
8. White
9. Black – mounted together with the existing black wire coming from the terminal block inside the box.
10. Red – mounted together with the existing red wire coming from the fuse holder.

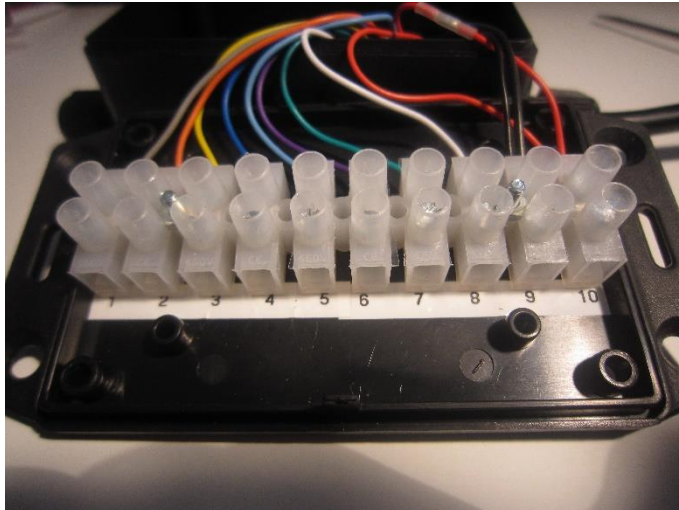

Connection to Sensors and External Units

In the below scheme is shown how the individual wires must be connected.

The wires from external units are connected via the glands, which must be tightened slightly without using tools. The glands ensure that the movements of the boat will not cause the wires to loose connection.

Terminal number	Wire color	Connected to
1	Grey	Signal GND – future use
2	Orange	TxD – future use
3	Yellow	RxD – future use
4	Blue	Output #2
5	Light blue	Output #1
6	Purple	Input #2
7	Green	Input #1
8	White	GND for Output #1
9	Black	Not to be connected to external equipment
10	Red	+12V can be used with Input #1 og Input #2 to source 12V through a potential free switch

12V Connection

The Connection Box must be connected to 12V on the primary side of the main switch of the boat, to ensure that the Alarm system is always connected to power when the boat is not used. This is a precondition for the Alarm system to monitor the boat when not in use.

Therefore the Connection Box contains a fuse, which protects the system in case of a short circuit.

12V is connected to the terminal block placed inside the Connection Box, as shown in the below picture.

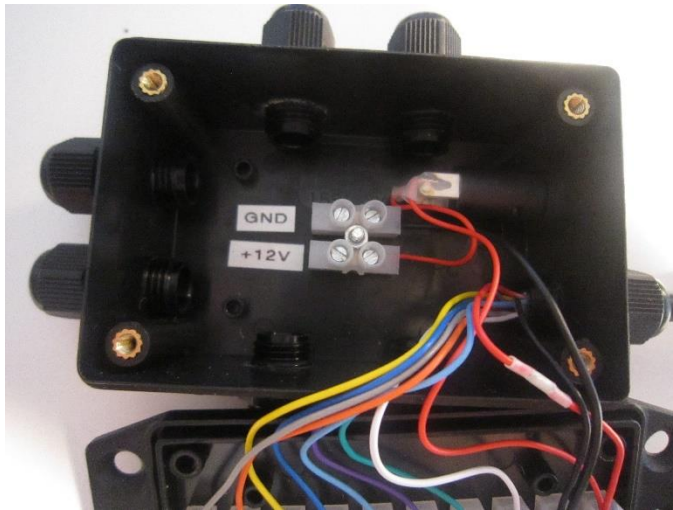

Outboard Engine Alarm

Input #1 can be used as Outboard Engine Alarm. A 1KOhm pull-up resistor must be installed between the Input #1 and +12V, as shown in the below picture.

The resistor is supplied with the Connection Box and is only to be used if the Outboard Engine alarm is used.

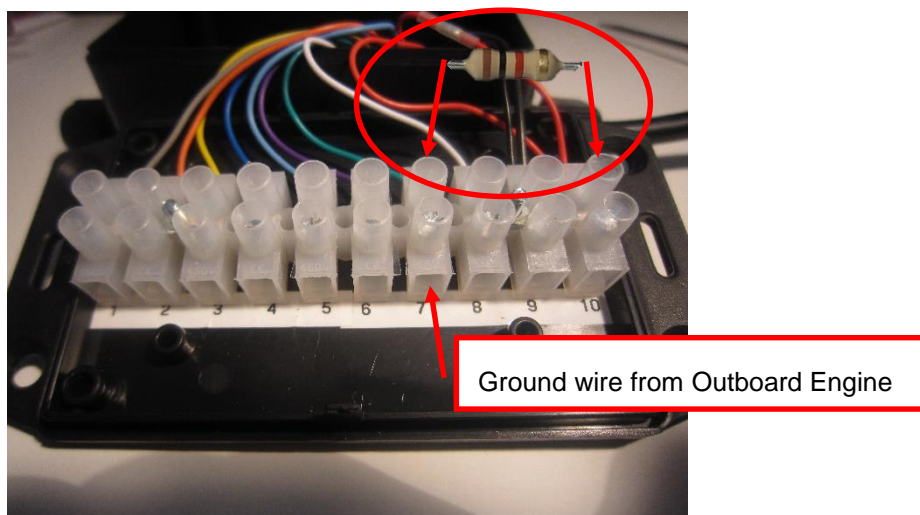

Input #1 which is now used as Outboard Engine alarm is activated in the app. As shown below.

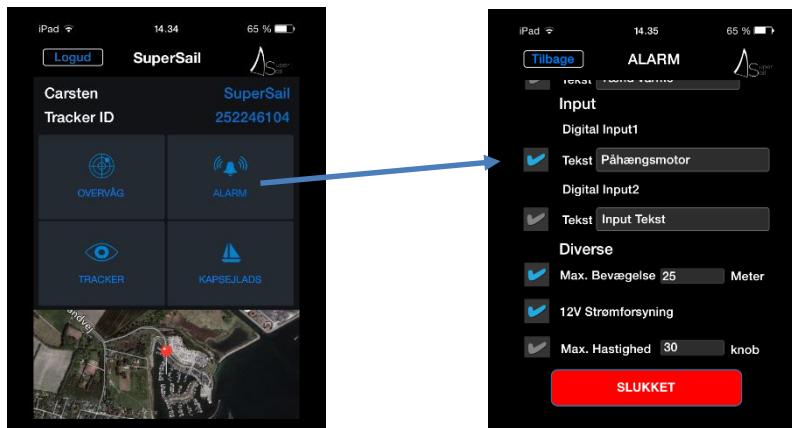

Maintenance

The Connection Box is maintenance free. Repairs should be carried out at an authorized service center.

Cleaning can be carried out with a soft cloth wrenched in lukewarm water.

Cleaning detergent containing solvent can harm the unit.

Technical Specifications

Color	Black
Material	ABS
Protection	IP54
Fuse	T2.5A
Size	87 x 57 x 39 mm (BxDxH)

Changes may apply.

Safe Disposal



Should not be disposed a domestic waste.

Electronic equipment should be disposed according to the local regulations for electronic and electronically equipment.